

# St Michael church, Berlin

## final study

LiDe3 2015 Workshop Project

Alaa ALCHADDOUD  
TIMIS GABRIEL  
DIMITRIS ILIADIS  
COSMIN TOPARCEAN,

.

# St Michael church, Berlin

## Goals of the project

- Highlight the destruction of the church
- There is no need for the entire building to be lit
- Focus on essentials
- Avoid any glare for the residents
- Minimum number of lighting fixtures
- satisfactory luminous efficacy
- hide the lighting fixtures
- Minimal approach



# St Michael church, Berlin

## Difficulties and challenges

- It is an almost pure residential and quite area
- the lighting should not disturb the flora and fauna of the area
- Trees create obstacles and shadows
- The church is a sculpture and not a worship building
- The church is accessible from all the directions
- Compliance with the standards



# St Michael church, Berlin

3D modeling



# St Michael church, Berlin

3D modeling

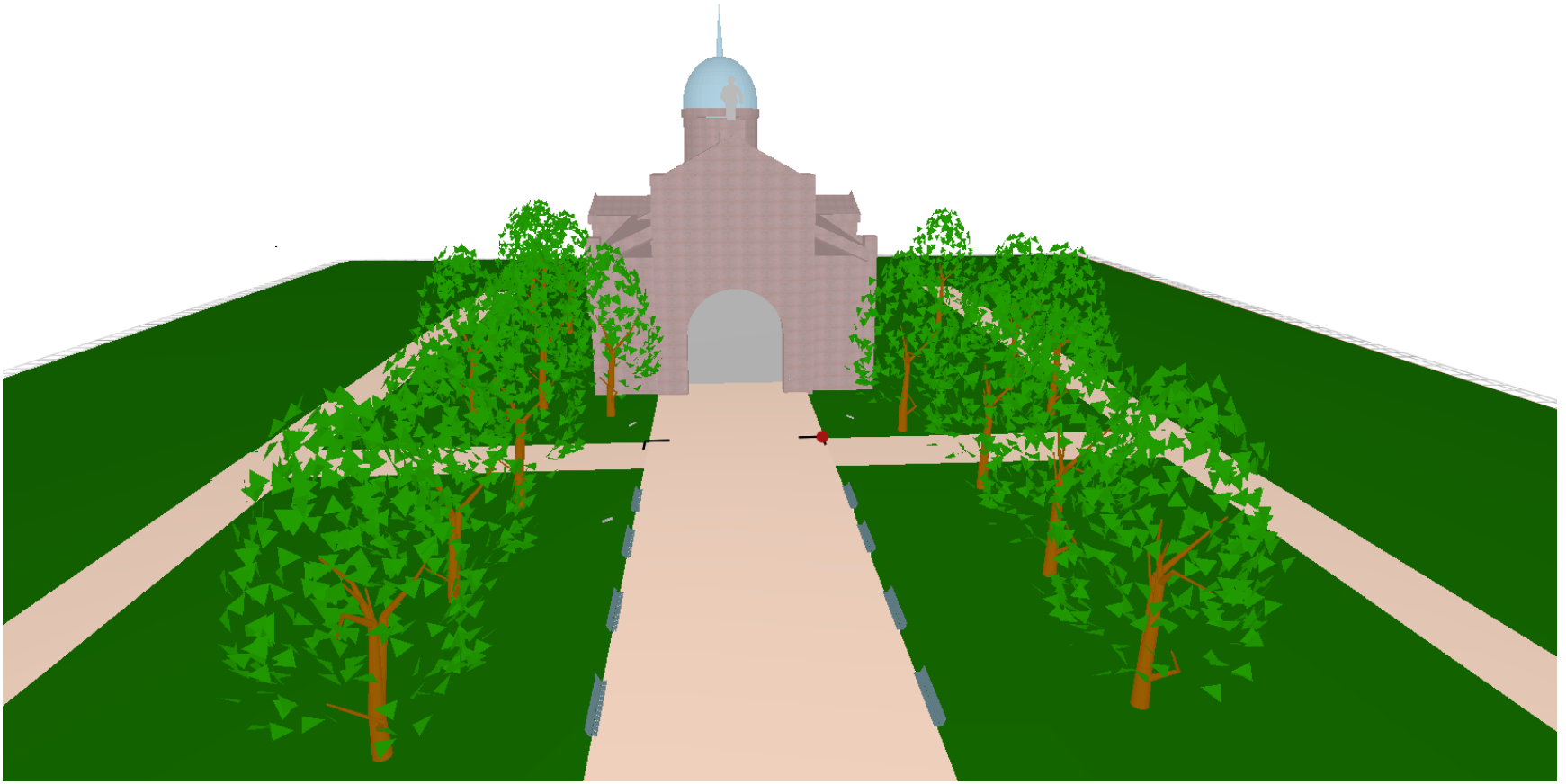

# St Michael church, Berlin

## Determination of the main entrance

### Luminaire data

Absolute Photometry	:	
Luminaire efficacy	:	63.95 lm/W
Classification	:	A41 $\nearrow$ 97.6% $\uparrow$ 2.4%
CIE Flux Codes	:	51 89 99 98 100
UGR 4H 8H (20%, 50%, 70%)	:	
C0 / C90	:	27.2 / 29.1
Control gear	:	electronic transformer
System power	:	56 W
Length	:	100 mm
Width	:	100 mm
Height	:	100 mm

### Equipped with

Quantity	:	1
Designation	:	LED
Colour	:	3200K
Luminous flux	:	3581 lm

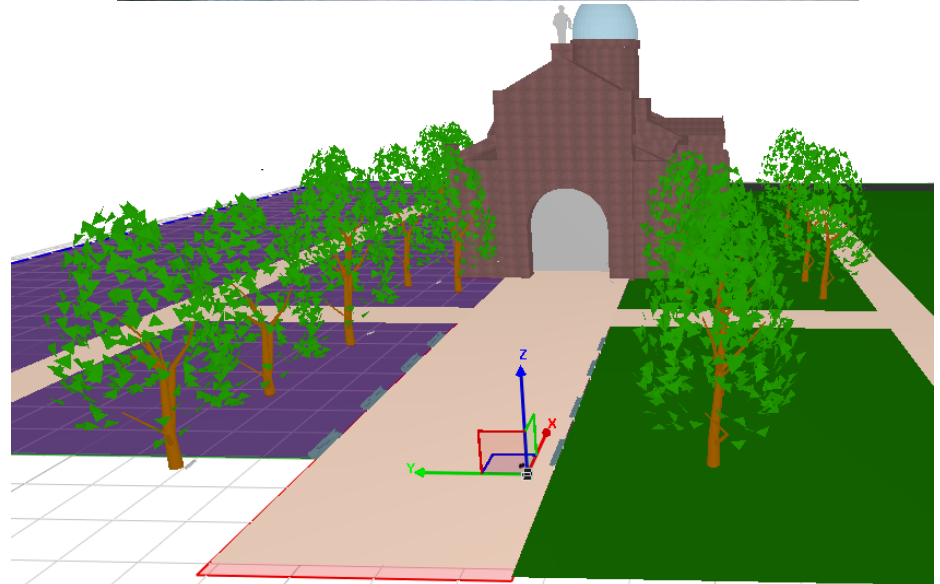
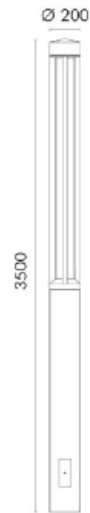
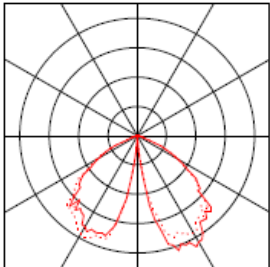



# St Michael church, Berlin

Determination of the main entrance

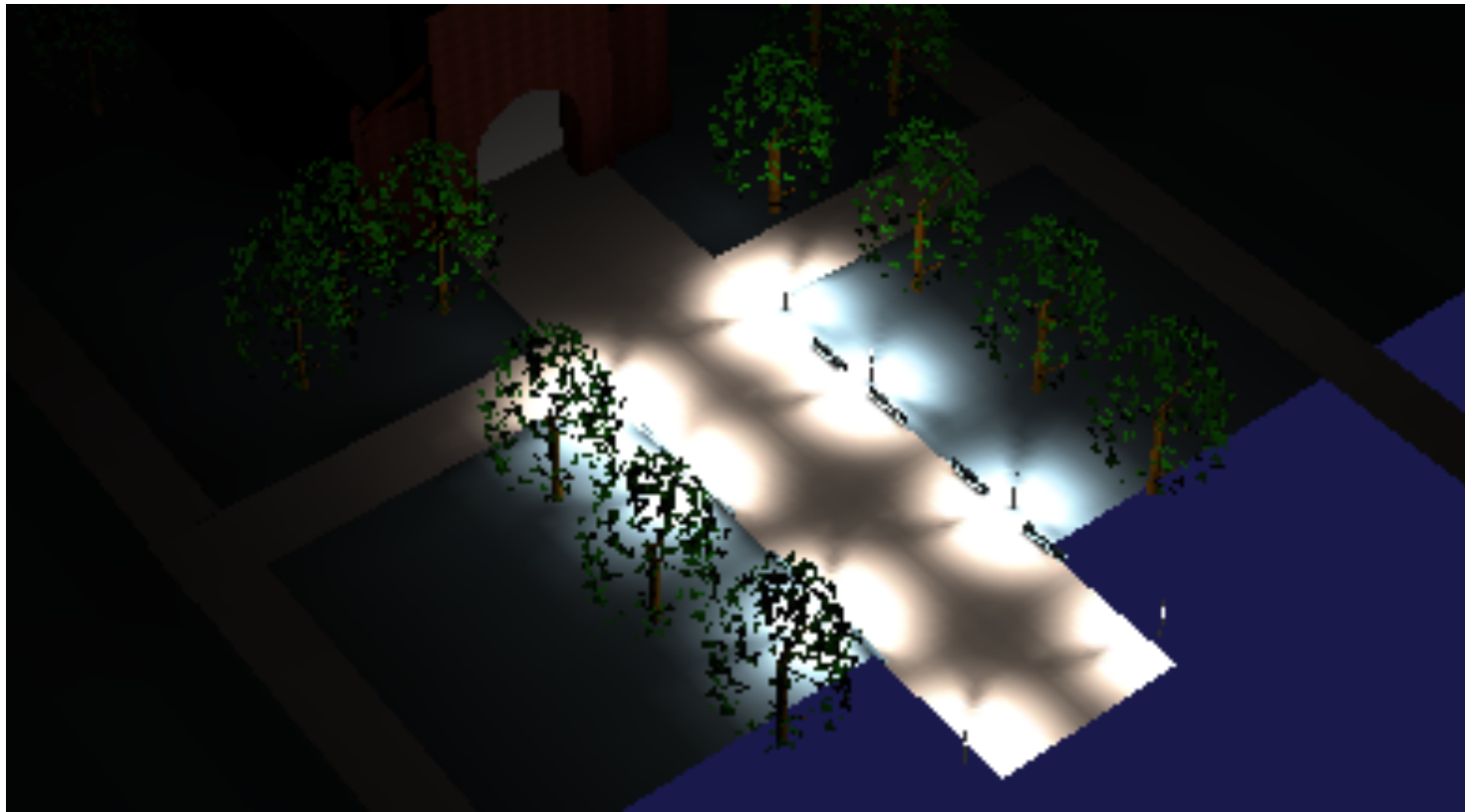

# St Michael church, Berlin

## Main façade

Luminaires at poles

Warm white 3200K, metal halide

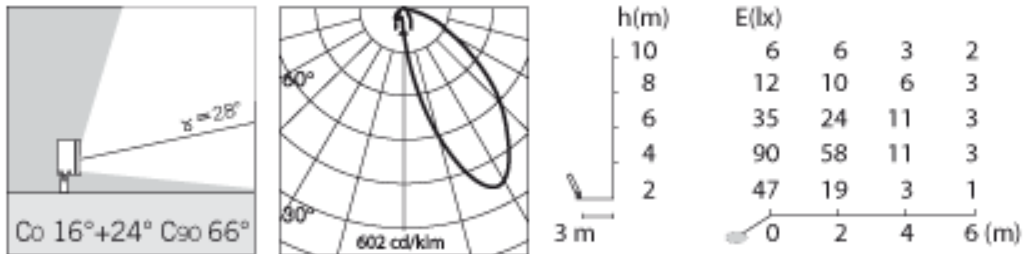



# St Michael church, Berlin

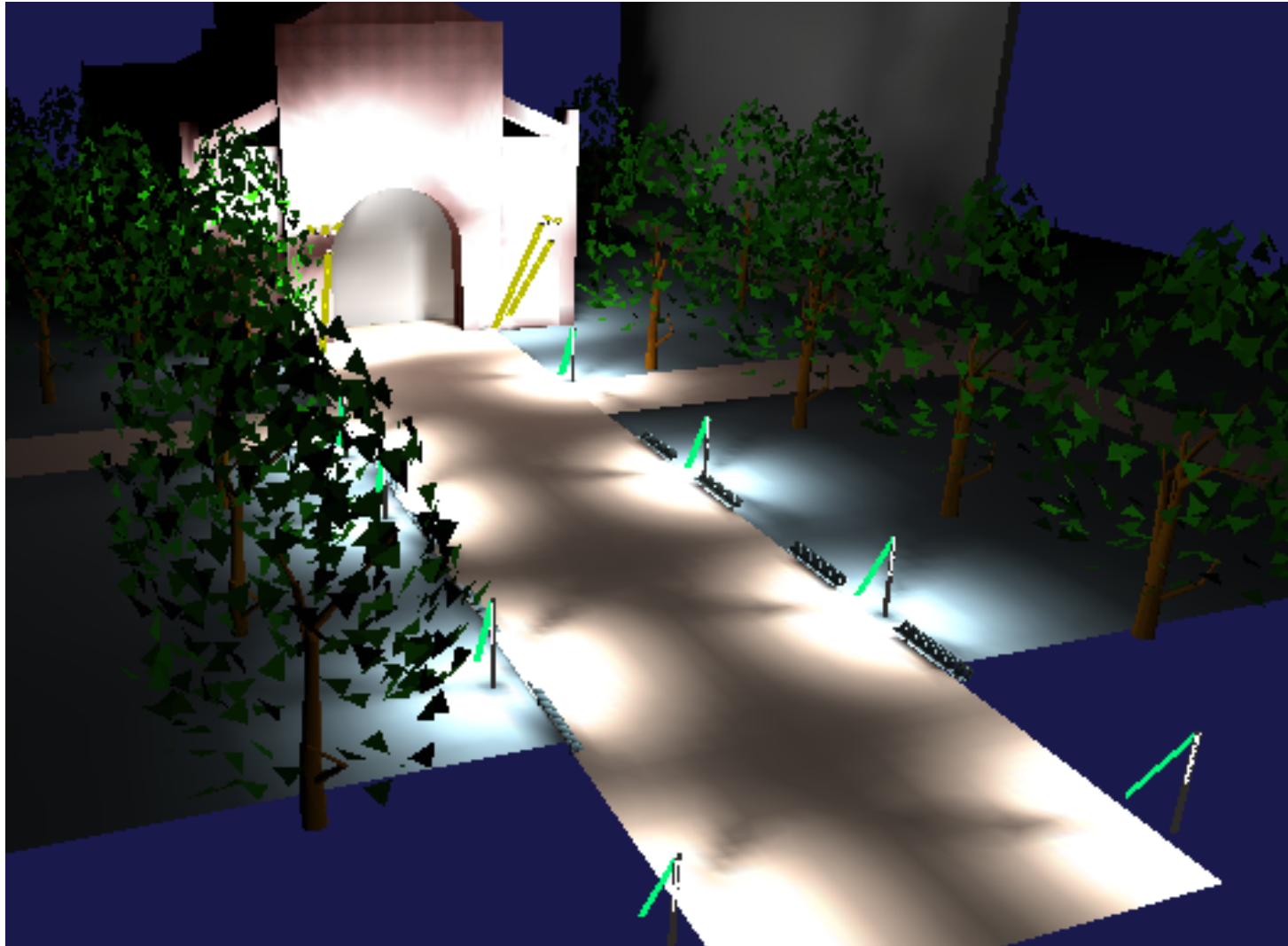

# St Michael church, Berlin

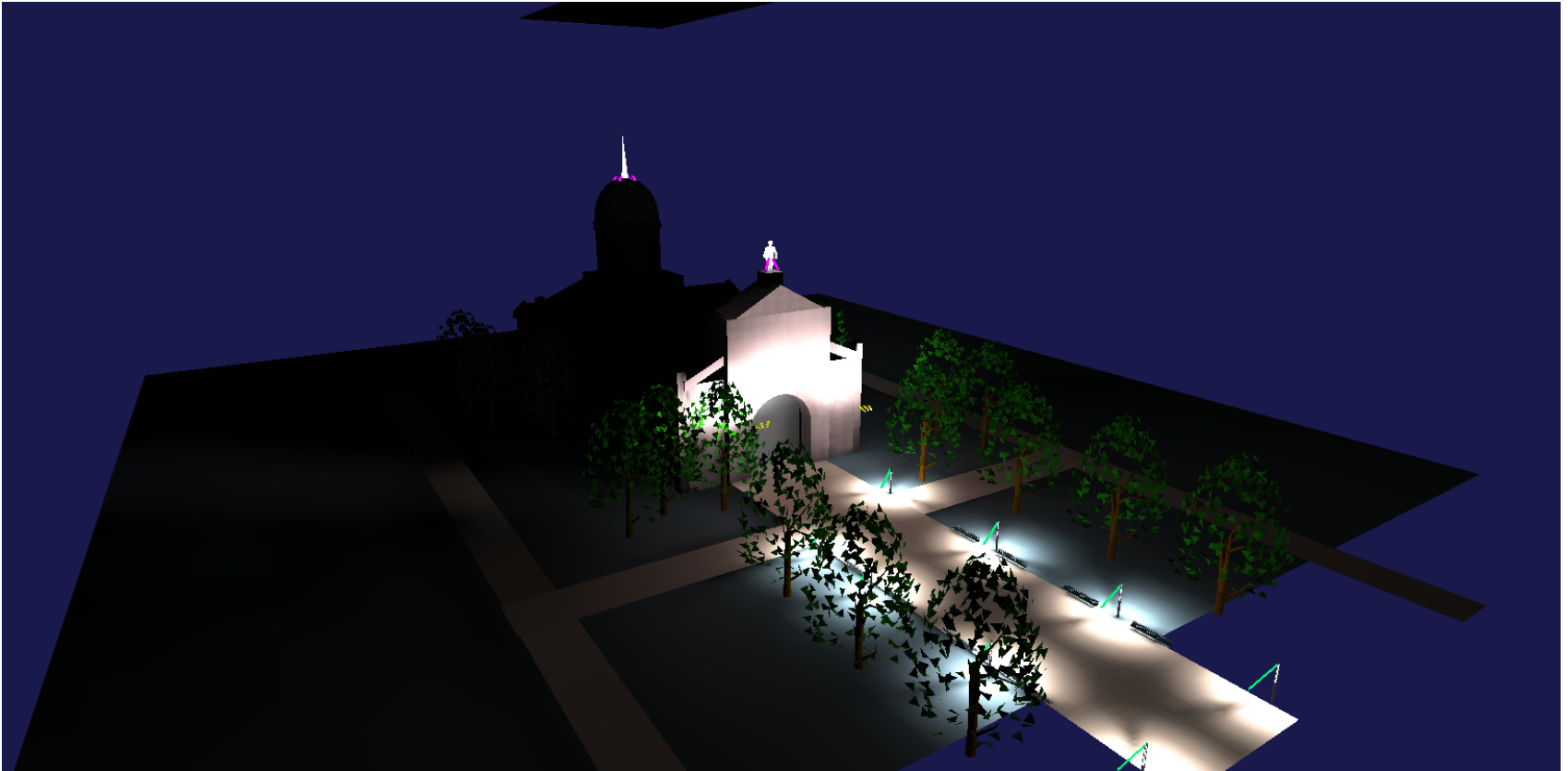

# St Michael church, Berlin



Luminaire data	
Luminaire efficiency	: 99.9%
Luminaire efficacy	: 62.72 lm/W
Classification	: A80 ? 100.0% ↑ 0.0%
CIE Flux Codes	: 97 99 100 100 98
UGR 4H 8H (20%, 50%, 70%)	
C0 / C90	: <10.0 / <10.0
Control gear	: electronic transformer
System power	: 17.7 W
Diameter	: 135 mm
Height	: 185 mm

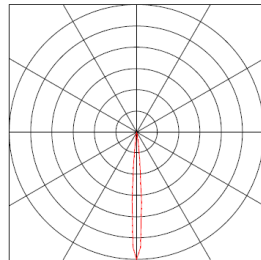

Equipped with	
Quantity	: 1
Designation	: LED
Colour	: 3200K
Luminous flux	: 1111.3 lm

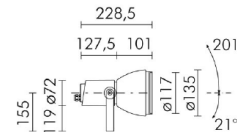

Bright cold white 6200K

Warm 2700K

time- definite operation :

MONDAY – FRIDAY - 11:00 p.m

SATURDAY – SUNDAY – 01:00 a.m

At least 6 hours per day  
All lights off

Total power installed 800W

